

FED. ROAD REG. NO.	STATE	PROJECT NO.	SHEET NO.
4	MISS.	6423	1

**GENERAL INDEX**

INCLUDED THIS PROJECT	BEGIN WITH SHEET
<input type="checkbox"/> ROADWAY .....	1
<input checked="" type="checkbox"/> PERMANENT SIGNS .....	1001
<input type="checkbox"/> TRAFFIC SIGNALS .....	2001
<input type="checkbox"/> ITS COMPONENTS .....	3001
<input type="checkbox"/> LIGHTING .....	4001
<input type="checkbox"/> (RESERVED) .....	5001
<input checked="" type="checkbox"/> ROADWAY STANDARD DWGS ..	6001
<input type="checkbox"/> BRIDGE STANDARD DWGS .....	7001
<input type="checkbox"/> BRIDGE .....	8001
<input type="checkbox"/> CROSS SECTIONS .....	9001

**EQUATIONS**  
NONE

**BOX BRIDGES REQ'D.**  
NONE

**BRIDGE STRUCTURES REQ'D.**  
NONE

**EXCEPTIONS**  
NONE

**BOARD OF SUPERVISORS**

- DISTRICT I     JOHN BELL CROSBY
- DISTRICT II    JOHN HOWLAND
- DISTRICT III    GERALD STEEN
- DISTRICT IV    KARL M. BANKS (PRESIDENT)
- DISTRICT V     PAUL GRIFFIN
- ATTORNEY      MIKE ESPY

**CONVENTIONAL SYMBOLS**

COUNTY LINE .....	
TOWN CORPORATION LINE .....	
SECTION LINE .....	
EXISTING ROAD OR TRAVELED WAY .....	
PROPOSED ROAD OR TRAVELED WAY .....	
RAILROAD .....	
SURVEY LINE .....	
BRIDGES .....	

LENGTH OF ROADWAY	FT.	0.0274	MI.
LENGTH OF BRIDGES	FT.		MI.
LENGTH OF PROJECT (NET)	FT.	0.0274	MI.
LENGTH OF EXCEPTIONS	FT.		MI.
LENGTH OF PROJECT (GROSS)	FT.		MI.

**LENGTH DATA**

**MADISON COUNTY**

**COUNTY HIGHWAY  
PLAN AND PROFILE OF PROPOSED  
PROJECT NO.  
6423**

**LAKE CAVALIER ROAD @ ANCIENT OAKS  
INTERSECTION IMPROVEMENTS**

**SCALES**

PLAN	1 IN. = 50 FT.
PROFILE	HOR. 1 IN. = 5 FT.
	VERT. 1 IN. = 1 FT.
LAYOUT	1 IN. = 1000 FT.

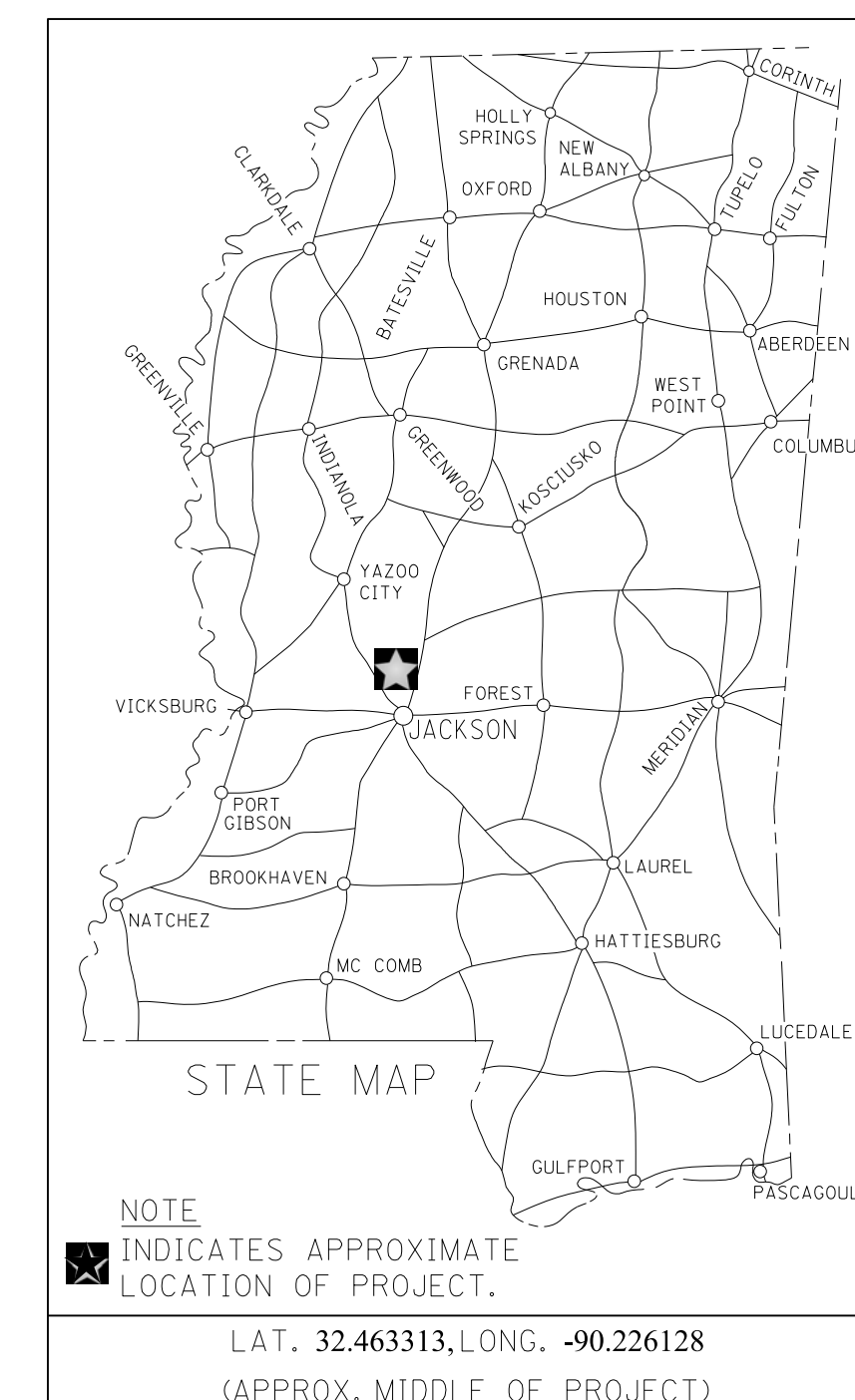
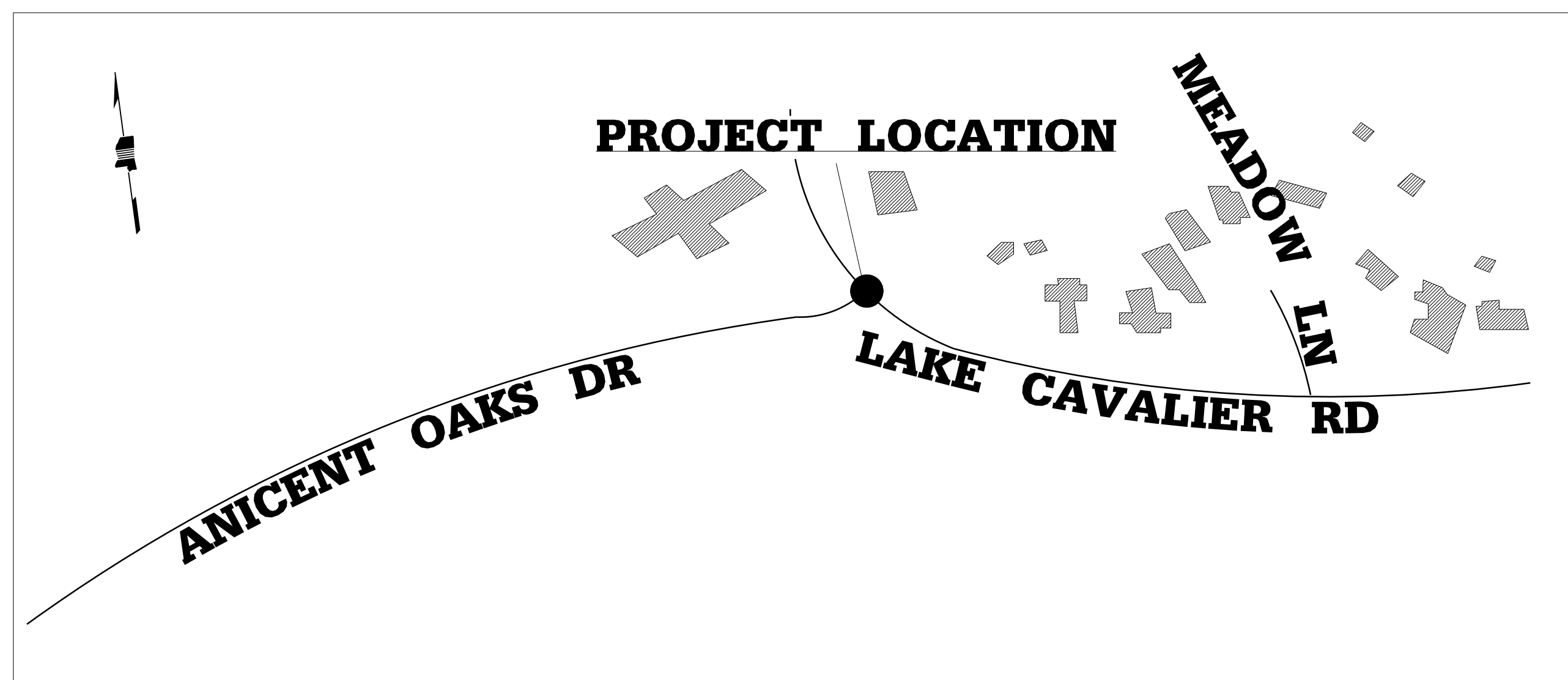

**DESIGN CONTROL**  
50 MPH = V (SPEED DESIGN)

ADT ( ) = ; ADT ( ) =  
DHV = ; D = % T = %

**PERMITS ACQUIRED BY MDOT**

WETLANDS AND WATERS PERMITS (NECESSARY FOR ULTIMATE IMPROVEMENTS ONLY):

	WATERS	WETLANDS
NATIONWIDE #14	<input type="checkbox"/>	<input type="checkbox"/>
NATIONWIDE (OTHER)*	<input type="checkbox"/>	<input type="checkbox"/>
GENERAL*	<input type="checkbox"/>	<input type="checkbox"/>
INDIVIDUAL (404)*	<input type="checkbox"/>	<input type="checkbox"/>

\* ACQUISITION OF PERMITS FOR TEMPORARY IMPACTS DURING CONSTRUCTION ARE THE RESPONSIBILITY OF THE CONTRACTOR

STORMWATER PERMIT [N]

Y REQUIRED CNDI SUBMITTED BY MDOT (DISTURBED AREA = 5 ACRES)

S REQUIRED SCNDI TO BE SUBMITTED BY CONTRACTOR (1 TO 4.99 ACRES)

N NO STORMWATER PERMIT REQUIRED (<1 ACRE)

APPROVED BY: \_\_\_\_\_ DATE: \_\_\_\_\_

PLANS STAGE	DATE PRINTED
<input type="checkbox"/> CONCEPTUAL	
<input type="checkbox"/> PRE-R.O.W.	
<input type="checkbox"/> FIELD INSPECTION	
<input checked="" type="checkbox"/> FINAL R.O.W.	
<input type="checkbox"/> R.O.W. REVISION	
<input type="checkbox"/> OFFICE REVIEW	

EXECUTIVE DIRECTOR \_\_\_\_\_ DATE \_\_\_\_\_

PREPARED BY:  
 WARNOCK & ASSOCIATES, L.L.C.  
ENGINEERING, MANAGEMENT & PLANNING

BRIAN P. SMITH, P.E. \_\_\_\_\_ DATE \_\_\_\_\_  
MS LICENCE NO. 20232



GENERAL NOTES

STATE	PROJECT NO.
MISS.	6423

CHANGES MAY BE REQUIRED WHEN PHYSICAL DIMENSIONS IN THE DETAIL

DRAWINGS, STANDARD DETAILS AND ROADWAY DETAILS ARE NOT ATTAINABLE TO MEET FIELD CONDITIONS, OR RESULT IN DUPLICATE, OR UNDESIRE OVERLAPPING OF DEVICES. MODIFICATION MAY INCLUDE: MOVING, SUPPLEMENTING, COVERING OR REMOVAL OF DEVICES, AS DIRECTED BY THE ENGINEER.

THE FOLLOWING GENERAL NOTES APPLY AT ALL TIMES FOR THE DURATION OF THE CONSTRUCTION PROJECT, EXCEPT WHEN OTHERWISE NOTED IN THE PLAN, OR DIRECTED BY THE ENGINEER.

TIME RESTRICTIONS

A) DO NOT CLOSE OR NARROW TRAVEL LANES AS FOLLOWS:

ROAD NAME	DAY AND TIME RESTRICTIONS
LAKE CAVALIER/ANCIENT OAKS RD	600AM TO 800AM AND FROM 400PM TO 600PM

LANE AND SHOULDER CLOSURE REQUIREMENTS

B) REMOVE LANE CLOSURE DEVICES FROM THE LANE WHEN WORK IS NOT BEING PERFORMED BEHIND THE LANE CLOSURE OR WHEN A LANE CLOSURE IS NO LONGER NEEDED, OR AS DIRECTED BY THE ENGINEER.

C) WHEN PERSONNEL AND/OR EQUIPMENT ARE WORKING WITHIN 15 FT OF AN AN OPEN TRAVEL LANE, CLOSE THE NEAREST OPEN SHOULDER

D) WHEN PERSONNEL AND/OR EQUIPMENT ARE WORKING ON THE SHOULDER ADJACENT TO AN UNDIVIDED FACILITY AND WITHIN 5 FT OF AN OPEN TRAVEL LANE, CLOSE THE NEAREST OPEN TRAVEL LANE UNLESS THE WORK AREA IS PROTECTED BY BARRIER OR GUARDRAIL.

E) WHEN PERSONNEL AND/OR EQUIPMENT ARE WORKING ON THE SHOULDER ADJACENT TO A DIVIDED FACILITY AND WITHIN 10 FT OF AN OPEN TRAVEL LANE, CLOSE THE NEAREST OPEN TRAVEL LANE UNLESS THE WORK AREA IS PROTECTED BY BARRIER OR GUARDRAIL.

F) WHEN PERSONNEL AND/OR EQUIPMENT ARE WORKING WITHIN A LANE OF TRAVEL OF AN UNDIVIDED OR DIVIDED FACILITY, CLOSE THE LANE ACCORDING TO THE TRAFFIC CONTROL PLANS, ROADWAY STANDARD DRAWINGS OR AS DIRECTED BY THE ENGINEER. CONDUCT THE WORK SO THAT ALL PERSONNEL AND/OR EQUIPMENT REMAIN WITHIN THE CLOSED TRAVEL LANE.

G) INSTALL ADVANCE WORK ZONE WARNING SIGNS WHEN WORK IS WITHIN 40 FT FROM THE EDGE OF TRAVEL LANE AND NO MORE THAN THREE (3) DAYS PRIOR TO THE BEGINNING OF CONSTRUCTION.

H) PROVIDE PERMANENT SIGNING.

I) ENSURE ALL NECESSARY SIGNING IS IN PLACE PRIOR TO ALTERING ANY TRAFFIC PATTERN.

TRAFFIC CONTROL DEVICES

J) SPACE CHANNELIZING DEVICES IN WORK AREAS NO GREATER THAN TWICE THE POSTED SPEED LIMIT (MPH), EXCEPT 10 FT ON-CENTER IN RADII, AND 3 FT OFF THE EDGE OF AN OPEN TRAVELWAY, WHEN LANE CLOSURES ARE NOT IN EFFECT. WHEN SKINNY DRUMS ARE ALLOWED, REFER TO SECTION 1180 OF STANDARD SPECIFICATIONS FOR ROADS AND STRUCTURES OR AS SHOWN IN THE PLANS.

K) ALL PLASTIC DRUMS SHALL HAVE A BALLASTING COLLAR MADE FROM RECYCLED TRUCK TIRES OR OTHER SUITABLE MATERIAL.

PAVEMENT MARKINGS AND MARKERS

L) INSTALL PAVEMENT MARKINGS AND PAVEMENT MARKERS ON THE FINAL SURFACE

AS FOLLOWS:		
ROAD NAME	MARKING	MARKER
LAKE CAVELIER RD	THERMOPLASTIC (PERM)	RAISED YELLOW/YELLOW & CLEAR/RED
ANCIENT OAKS RD	THERMOPLASTIC (PERM)	RAISED YELLOW/YELLOW & CLEAR/RED

M) TIE PROPOSED PAVEMENT MARKING LINES TO EXISTING PAVEMENT MARKING LINES.

N) REMOVE/REPLACE ANY CONFLICTING/DAMAGED PAVEMENT MARKINGS AND MARKERS BY THE END OF EACH DAY'S OPERATION.

O) REMOVAL OF RAISED PAVEMENT MARKERS THAT ARE IN CONFLICT WITH REQUIRED CONSTRUCTION IS NOT CONSIDERED A SEPARATE PAY ITEM. COST TO BE ABSORBED IN OTHER ITEMS BID.

P) REMOVAL OF OBJECT MARKERS IS NOT CONSIDERED A SEPARATE PAY ITEM, AND SHALL BE ABSORBED IN OTHER ITEMS BID. ERECTION DATES ARE TO BE LEGIBLY WRITTEN ON THE BACK OF ALL SIGNS WITH A SANFORD MEANSTREAK WATERPROOF FORMULA PERMANENT MARKING STICK.

Q) ROADWAY SIGNS THAT ARE IN CONFLICT WITH CONSTRUCTION OF THIS PROJECT SHALL BE REMOVED AND RELOCATED BY THE CONTRACTOR AS DIRECTED BY THE ENGINEER, THE COST OF WHICH SHALL BE ABSORBED IN OTHER ITEMS BID.

Miscellaneous

R) THE CONTRACTOR SHALL BE RESPONSIBLE FOR PROTECTING EXISTING STRUCTURES SUCH AS, BUT NOT LIMITED TO, PIPES, INLETS, APRONS AND BRIDGES FROM DAMAGE WHICH MIGHT OCCUR DURING CONSTRUCTION. THE CONTRACTOR SHALL REPLACE OR REPAIR, AS DIRECTED BY THE ENGINEER, ANY STRUCTURES DAMAGED DURING THE LIFE OF THE CONTRACT. NO PAYMENT WILL BE MADE FOR REPLACEMENT OR REPAIR OF DAMAGED ITEMS.

S) VOIDS CREATED BY THE REMOVAL OF, BUT NOT LIMITED TO, POSTS, CONCRETE ANCHORS, AND FOOTINGS SHALL BE BACKFILLED AND TAMPED IN ACCORDANCE WITH SECTION 203 OF THE MISSISSIPPI STANDARD SPECIFICATIONS FOR ROAD AND BRIDGE CONSTRUCTION.

UTILITIES ON THE DRAWINGS ARE SHOWN IN THEIR ORIGINAL LOCATION BASED UPON THE BEST INFORMATION AVAILABLE TO THE ENGINEER. UTILITIES THAT WERE FOUND TO BE IN CONFLICT WITH CONSTRUCTION HAVE BEEN RELOCATED. PERMITS ARE ON FILE WITH THE DEPARTMENT SHOWING THE APPROXIMATE LOCATION OF UTILITIES RELOCATED WITHIN THE RIGHT-OF-WAY. THE ENGINEER CAN NOT AND DOES NOT WARRANT THAT THIS INFORMATION IS COMPLETE OR ACCURATE. THE CONTRACTOR MUST COORDINATE DIRECTLY WITH THE INVOLVED UTILITY OWNERS TO HAVE UNDERGROUND UTILITY LINES FIELD LOCATED IN ADVANCE OF CONSTRUCTION. (NO UTILITIES HAVE BEEN LOCATED.)

T) LIST OF PUBLIC UTILITIES

- ENTERGY 1-800-968-8243
- ATMOS 1-888-286-6700
- BEAR CREEK WATER ASSOCIATION (601) 856-5969
- AT&T (601) 826-5044

U) THE CONTRACTOR SHALL REPAIR ANY DAMAGE TO THE SURFACE TREATED SHOULDER THAT MIGHT OCCUR DURING CONSTRUCTION. ANY REPAIR TO SHOULDER WILL BE IN ACCORDANCE WITH SECTION 410 OF THE MISSISSIPPI STANDARD SPECIFICATIONS FOR ROAD AND BRIDGE CONSTRUCTION. NO PAYMENT WILL BE MADE FOR REPAIR OF DAMAGED SHOULDER. IF COLORS ARE USED ON PLAN/PROFILE SHEETS, THEY ARE INTENDED TO VISUALLY EASE THE LOCATION OF ELEMENTS FOR USERS OF THESE DRAWINGS. ALTHOUGH THE INTENT IS TO CATEGORIZE EVERYTHING AS EITHER EXISTING OR PROPOSED, IT IS THE END USERS RESPONSIBILITY TO ENSURE ALL ELEMENTS ARE INTERPRETED CORRECTLY REGARDLESS OF COLOR.

ROADWAY PLAN DIVISION MISSISSIPPI DEPARTMENT OF TRANSPORTATION

7/15/2015 08:54:47 GENERAL NOTES.DGN

		BY		MISSISSIPPI DEPARTMENT OF TRANSPORTATION	
		REVISION		GENERAL NOTES	
				ANCIENT OAKS ROAD @ LAKE CAVALIER ROAD INTERSECTION CONSTRUCTION	
				COUNTY: MADISON	
				PROJ. NUM.: 6423	
		DATE		FILENAME: GENERAL NOTES.DGN	
				DESIGN TEAM W & A CHECKED BS DATE JULY 2015	
				WORKING NUMBER GN - 1	
				SHEET NUMBER 3	

### SUMMARY OF QUANTITIES (SHEET 1)

PAY ITEM NO.	PAY ITEM	UNIT	PRELIMINARY	FINAL
<b>*****Removal Items*****</b>				
202-B070	REMOVAL OF SIGN INCLUDING POST & FOOTING	EA	1	
202-B076	REMOVAL OF TRAFFIC STRIPE	LF	225	
<b>*****Incidental Construction Items*****</b>				
618-A001	MAINTENANCE OF TRAFFIC	LS	100%	
<b>*****Traffic Control Items*****</b>				
620-A001	MOBILIZATION	LS	100%	
<b>*****Pavement Marking Items*****</b>				
907-626-XXX	4" THERMOPLASTIC DOUBLE DROP TRAFFIC STRIPE, CONTINOUS WHITE	LF	715	
907-626-XXX	4" TRHERMOPLASIC DOUBLE DROP TRAFFIC STRIPE, CONTINOUS YELLOW	LF	650	
907-626-G006	THERMOPLASTIC DOUBLE DROP DETAIL STRIPE, WHITE	LF	55	
627-K001	RED-CLEAR REFLECTIVE HIGH PERFORMANCE RAISED MARKERS	EA	24	
627-L001	TWO-WAY YELLOW REFLECTIVE HIGH PERFORMANCE RAISED MARKERS	EA	8	
<b>*****Traffic Signs and Delineator Items*****</b>				
630-A002	STANDARD ROADSIDE SIGNS, SHEET ALUMINUM, 0.125" THICKNESS	SF	60	
630-C003	STEEL U-SECTION POSTS, 3.0 LB/FT	LF	120	
<b>*****Special Provision Items*****</b>				
ECO-118-D12	ECO Continuous flash 24/7, double 12' LED yellow/amber, polocarbonate head, 40 watt solar panel, with mounting bracket, aluminum two space battery box. Splasher, solar power package including batteries and mounting hardware to mount to new aluminum breakaway post. K&K Systems or other Equivalent model of equipment shall be used. (unit should include sign, aluminum breakaway post, and lighting)	EA	2	

NOTE: ALL YOU CHANNEL POST MUST BE BREAKWAY COSTS TO BE ABSORBED IN WITH LF OF POSTS.

ROADWAY PLAN DIVISION MISSISSIPPI DEPARTMENT OF TRANSPORTATION

7/16/2015 1:54:22:22 SQS.DGN

<b>MISSISSIPPI DEPARTMENT OF TRANSPORTATION</b> <b>SUMMARY OF QUANTITIES</b>	
PROJECT NO. 6423 MADISON COUNTY	
FILENAME: SQS.DGN <small>DESIGN TEAM    W&amp;A    CHECKED    BS    DATE</small>	WORKING NUMBER <b>SQ-1</b> SHEET NUMBER <b>4</b>



STATE	PROJECT NO.
MISS.	6423



PLAN DIVISION MISSISSIPPI DEPARTMENT OF TRANSPORTATION  
001.00.AMPM.DGN FILENAME  
MDDDY

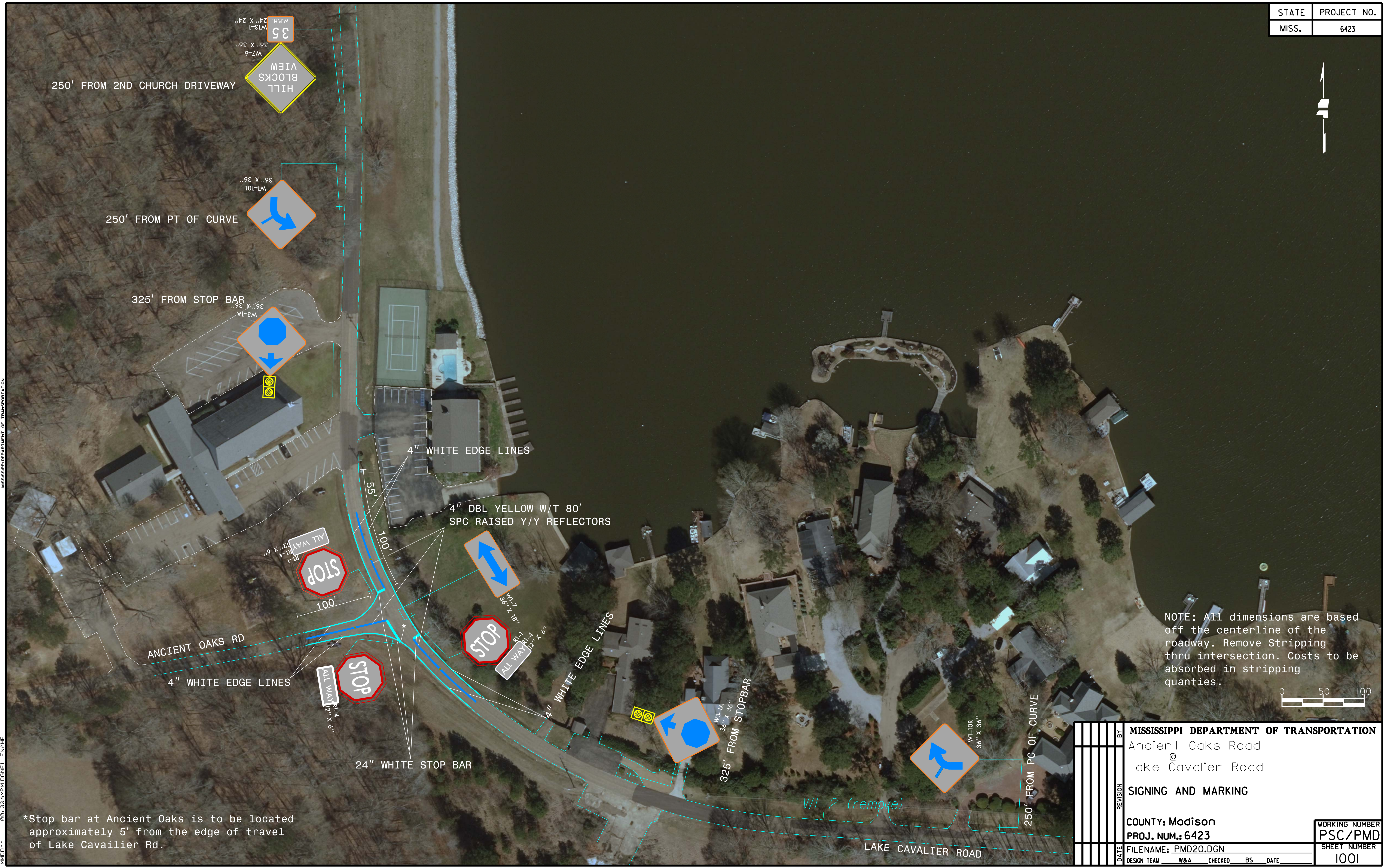

NOTE: All dimensions are based off the centerline of the roadway. Remove Stripping thru intersection. Costs to be absorbed in stripping quantities.



\*Stop bar at Ancient Oaks is to be located approximately 5' from the edge of travel of Lake Cavalier Rd.

BY	MISSISSIPPI DEPARTMENT OF TRANSPORTATION		
REVISION	Ancient Oaks Road @ Lake Cavalier Road		
	SIGNING AND MARKING		
	COUNTY: Madison		
	PROJ. NUM.: 6423		
DATE	FILENAME: PMD20.DGN	WORKING NUMBER	PSC/PMD
DESIGN TEAM	W&A	CHECKED	BS DATE
			SHEET NUMBER
			1001



# TYPICAL FOR RAISED PAVEMENT MARKERS PLACED ON SIDE ROAD RADIUS 2-LANE, 2-WAY TRAFFIC

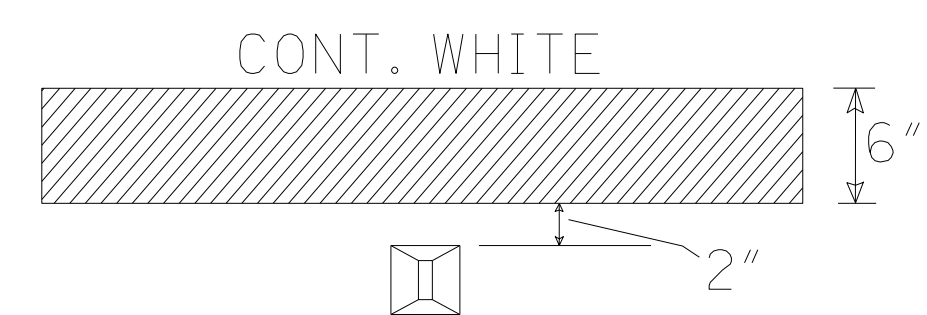
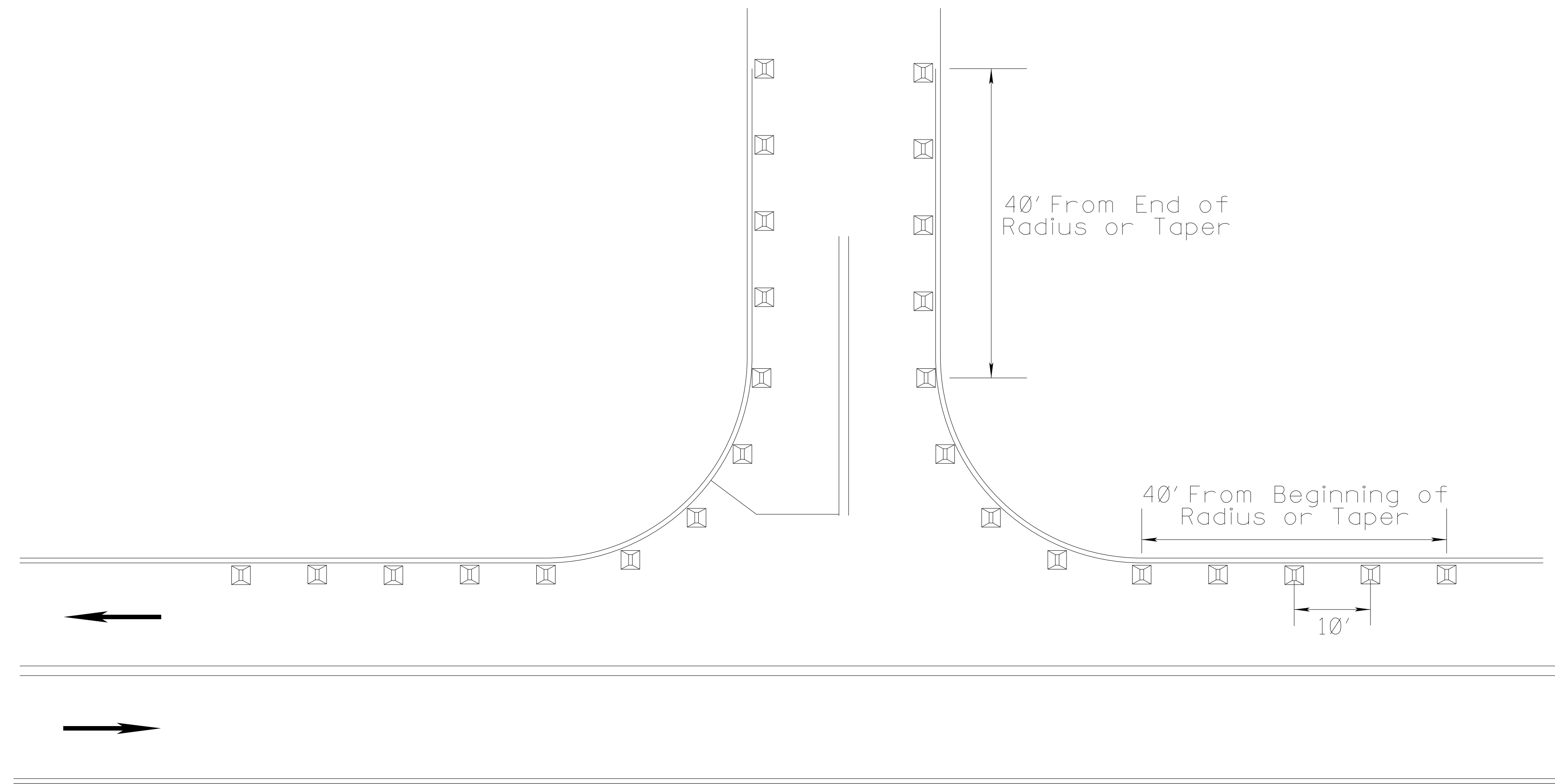

DETAIL A

- NOTE 1: MARKERS SHALL BE PLACED EVERY 10 FEET.
- NOTE 2: MARKERS SHALL BE VISIBLE FROM THE TRAVELING MOTORIST ON STATE DESIGNATED HIGHWAYS.
- NOTE 3: MARKERS SHALL BE HIGH PERFORMANCE TWO WAY CLEAR.
- NOTE 4: FIVE (5) MARKERS SHALL BE PLACED ALONG MAINLINE EDGE STRIPE.
- NOTE 5: MARKERS FOR COUNTY ROADS SHALL CONTINUE DOWN THE EDGE STRIPE A DISTANCE OF 40 FEET.
- NOTE 6: MARKERS SHALL NOT BE ROTATED WHEN BEING PLACED ALONG RADIUS OF LOCAL ROAD.

→ DIRECTION OF TRAFFIC

BY		MISSISSIPPI DEPARTMENT OF TRANSPORTATION	
REVISION		2-LANE, 2-WAY	
DATE		2-WAY CLEAR RAISED PAVEMENT MARKERS PLACED ON SIDE ROADS	
DESIGN TEAM		PROJECT NO. 6423 COUNTY : MADISON	
W&A		FILENAME: SP\SIDERDRPM.DGN	
CHECKED		DATE: JULY 2015	
BS		WORKING NUMBER CRPMSR-2	
DATE		SHEET NUMBER 1002	

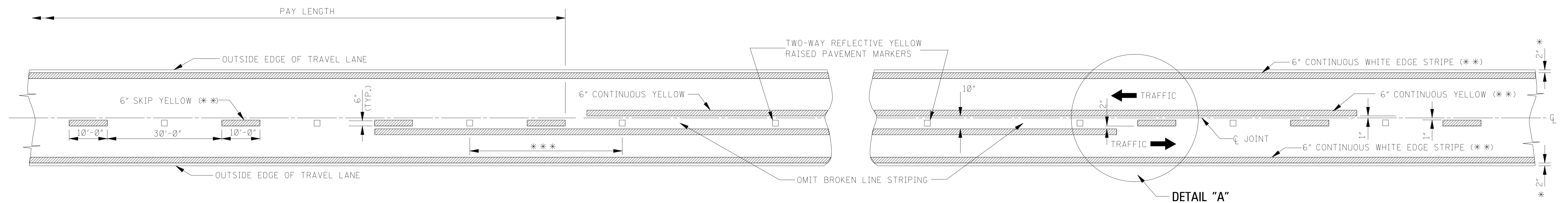

**TWO-WAY TRAFFIC**  
(ASPHALT OR CONCRETE PAVEMENT)

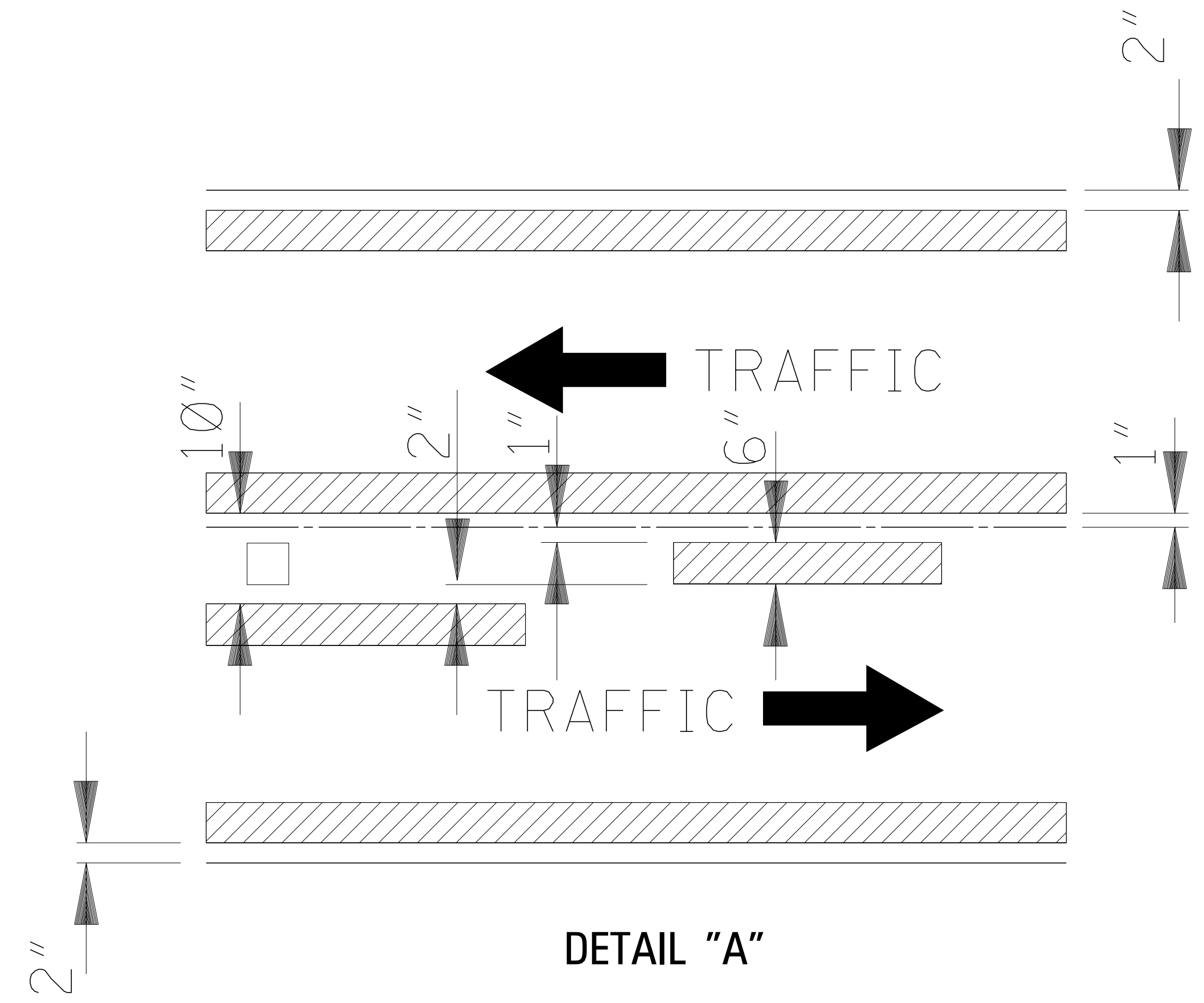

**GENERAL NOTES:**

- \* 1. 2" UNLESS SHOWN ELSEWHERE ON THE PLANS.
- \*\* 2. EDGE STRIPE SHALL BE SAME MATERIAL AS LANE-LINE STRIPE (PAINT OR PLASTIC AS INDICATED IN PAY ITEMS).
- \*\*\* 3. SPACING OF REFLECTIVE RAISED PAVEMENT MARKERS IS AS FOLLOWS:

	URBAN AREA (ft-in)	RURAL AREA (ft-in)
TANGENT SECTIONS	40'-0"	80'-0"
HORIZONTAL CURVES	40'-0"	40'-0"
INTERCHANGE LIMITS	40'-0"	+ 40'-0"

- † NOTE: ON THE MAIN FACILITY, REFLECTIVE RED-CLEAR RAISED PAVEMENT MARKERS ON A 40'-0" SPACING WILL BE REQUIRED ON LANE-LINE(S) THROUGH ALL INTERCHANGE AREAS BEGINNING 1000' IN ADVANCE (IN DIRECTION OF TRAFFIC) OF THE EXIT RAMP TAPER AND CONTINUING THROUGH THE INTERCHANGE TO THE END OF THE ENTRANCE RAMP TAPER.
- 4. PAVEMENT MARKERS SHALL BE HIGH PERFORMANCE REFLECTIVE RAISED PAVEMENT MARKERS AS LISTED IN THE MDOT "APPROVED SOURCES OF MATERIALS."

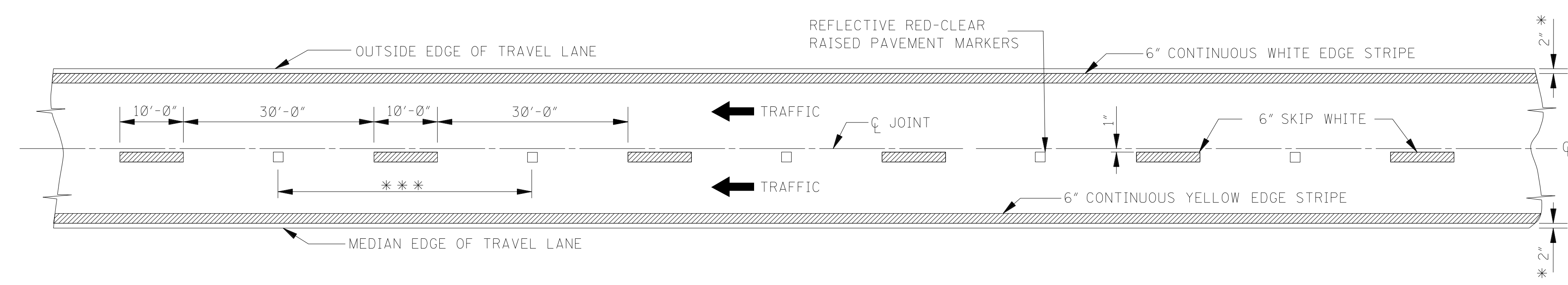

**4-LANE WITH ONE-WAY TRAFFIC**

BY		MISSISSIPPI DEPARTMENT OF TRANSPORTATION ROADWAY DESIGN DIVISION STANDARD PLAN	
REVISION		<b>PAVEMENT MARKING DETAILS FOR 2-LANE AND 4-LANE DIVIDED HIGHWAYS</b>	
DATE	ISSUE DATE:	JULY 2015	WORKING NUMBER PM-1
			SHEET NUMBER 6120

SIGN NUMBER	R1-1	R1-101	R1-2	R1-102	R2-1	R2-101	R2-102	R2-104	R3-1	R3-2	R3-3	R3-4	R3-5	R4-103
ALUMINUM (6061-T6) SIGN BLANK THICKNESS	0.080"	0.125"	0.125"	0.125"	0.080"	0.125"	0.125"	0.125"	0.080"	0.080"	0.080"	0.080"	0.080"	0.125"
LEGEND														
LETTER & NUMERAL SERIES	12" SERIES "C"	16" SERIES "C"	3" SERIES "C"	5" SERIES "C"	4" SERIES "E" 4" SERIES "E" 10" SERIES "E"	8" SERIES "E" 8" SERIES "E" 16" SERIES "E"	8" SERIES "D" 16" SERIES "E"	8" SERIES "C" 8" SERIES "C" 16" SERIES "D"			6" SERIES "D" 5" SERIES "D"		6" SERIES "D"	8" SERIES "D"
WIDTH OF BORDER INSIDE OUTSIDE	7/8" WHITE	1/4" WHITE	5" RED 3/4" WHITE	8" RED 1/2" WHITE	5/8" BLACK 3/8" WHITE	1/4" BLACK 3/4" WHITE	1/4" BLACK 3/4" WHITE	7/8" BLACK 3/4" WHITE	3/4" BLACK 1/2" WHITE	3/4" BLACK 1/2" WHITE	5/8" BLACK 3/8" WHITE	3/4" BLACK 1/2" WHITE	3/4" BLACK 1/2" WHITE	1/4" BLACK 3/4" WHITE
SIZE (WIDTH X HEIGHT)	36" OCTAGON	48" OCTAGON	36" EQUIL. TRIANGLE	60" EQUIL. TRIANGLE	24" X 30"	48" X 60"	48" X 48"	48" X 48"	30" X 30"	30" X 30"	24" X 24"	30" X 30"	30" X 36"	48" X 60"
COLORS COPY BACKGROUND	WHITE RED	WHITE RED	RED WHITE	RED WHITE	BLACK WHITE	BLACK WHITE	BLACK WHITE	BLACK WHITE	BLACK & RED WHITE	BLACK & RED WHITE	BLACK WHITE	BLACK & RED WHITE	BLACK WHITE	BLACK WHITE
REFLECTORIZATION	ALL	ALL	ALL	ALL	B'GROUND	B'GROUND	BACKGROUND	BACKGROUND	BACKGROUND, CIRCLE, & DIAGONAL	BACKGROUND, CIRCLE, & DIAGONAL	BACKGROUND	BACKGROUND, CIRCLE, & DIAGONAL	BACKGROUND	BACKGROUND
NUMBER OF POSTS FOR MOUNTING	1	1	1	1	1	1	---	---	1	1	1	1	1	1
NUMBER OF HOLES TO BE PUNCHED (3/8" DIA.)	2	4	2	4	2	6	4	4	2	2	2	2	2	6
PUNCHING DISTANCE FROM EACH VERTICAL EDGE	18" (VERT. CENTER)	10"	18" (VERT. CENTER)	20"	12" (VERT. CENTER)	10"	10"	10"	15" (VERT. CENTER)	15" (VERT. CENTER)	12" (VERT. CENTER)	15" (VERT. CENTER)	15" (VERT. CENTER)	10"
PUNCHING DISTANCE FROM TOP EDGE	3"; 33"	10"; 38"	2"; 26"	3"; 27"	3"; 27"	4"; 30"; 56"	4"; 44"	4"; 44"	3"; 27"	3"; 27"	3"; 21"	3"; 27"	3"; 33"	4"; 30"; 56"

SIGN NUMBER	R4-7	R4-107	R4-8	R5-1	R5-101	R5-1a	R6-1L, R6-1R	R6-2L, R6-2R	R8-104	R11-101
ALUMINUM (6061-T6) SIGN BLANK THICKNESS	0.080"	0.125"	0.080"	0.080"	0.125"	0.125"	0.125"	0.080"	0.125"	0.125"
LEGEND										
LETTER & NUMERAL SERIES	R=1/2"	R=2/4"	R=1/8"	4" SERIES "D"	6" SERIES "D"	8" SERIES "D"	4" SERIES "D"	5" SERIES "D"	6" SERIES "D"	10" SERIES "C"
WIDTH OF BORDER INSIDE OUTSIDE	5/8" BLACK 3/8" WHITE	7/8" BLACK 5/8" WHITE	5/8" BLACK 3/8" WHITE	WHITE OUT- SIDE BORDER	WHITE OUT- SIDE BORDER	1" WHITE	1/2" WHITE	5/8" BLACK 3/8" WHITE	7/8" BLACK 5/8" WHITE	1/4" BLACK 3/4" WHITE
SIZE (WIDTH X HEIGHT)	24" X 30"	36" X 48"	24" X 30"	30" X 30"	42" X 42"	42" X 36"	36" X 12"	18" X 24"	48" X 36"	48" X 60"
COLORS COPY BACKGROUND	BLACK WHITE	BLACK WHITE	BLACK WHITE	WHITE RED	WHITE RED	WHITE RED	BLACK (WHITE ARROW) BLACK	BLACK WHITE	BLACK WHITE	BLACK WHITE
REFLECTORIZATION	BACKGROUND	BACKGROUND	BACKGROUND	ALL	ALL	ALL	ARROW & BORDER	BACKGROUND	BACKGROUND	BACKGROUND
NUMBER OF POSTS FOR MOUNTING	1	1	1	1	1	1	1	1	2	1
NUMBER OF HOLES TO BE PUNCHED (3/8" DIA.)	2	4	2	2	4	4	2	2	4	6
PUNCHING DISTANCE FROM EACH VERTICAL EDGE	12" (VERT. CENTER)	5"	12" (VERT. CENTER)	15" (VERT. CENTER)	8"	8"	18" (VERT. CENTER)	9" (VERT. CENTER)	10"	10"
PUNCHING DISTANCE FROM TOP EDGE	3"; 27"	4"; 44"	3"; 27"	3"; 27"	4"; 38"	3"; 33"	1/2"; 10/2"	3"; 21"	6"; 30"	4"; 30"; 56"





GENERAL NOTES:

1. THE QUANTITIES LISTED ON THE SUMMARY OF QUANTITIES SHEET FOR THE SIGNS SHOWN ON THIS SHEET WILL BE USED AS THE BASIS FOR FINAL PAYMENT, EXCEPT WHERE SIGNS ARE MODIFIED FROM THAT SHOWN.
2. THE SPEED LIMITS REQUIRED ON SIGNS R2-1 AND R2-101 WILL BE SHOWN ON INDIVIDUAL PLAN SHEETS.

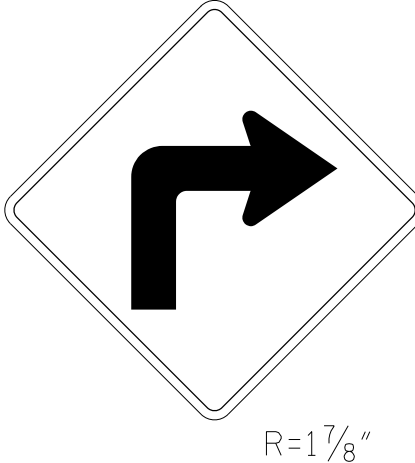
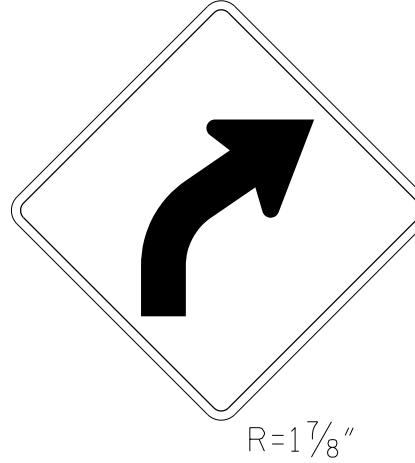
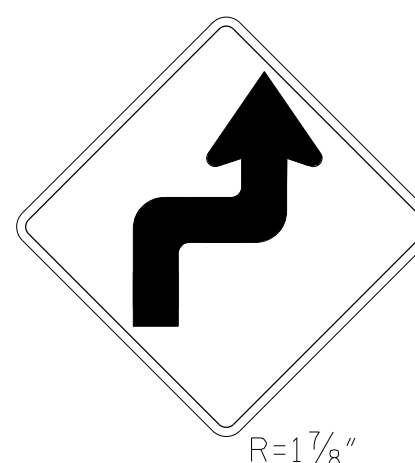
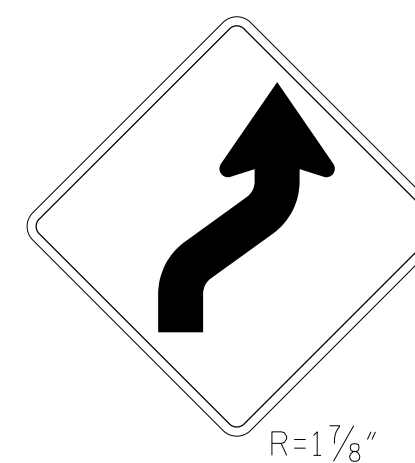
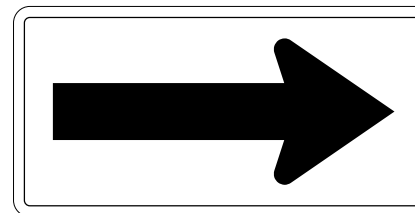
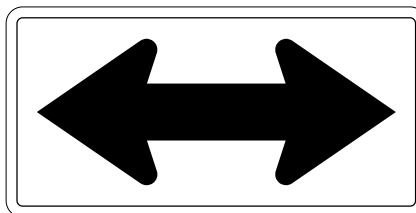
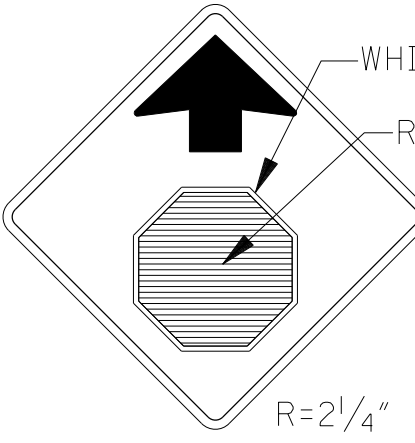
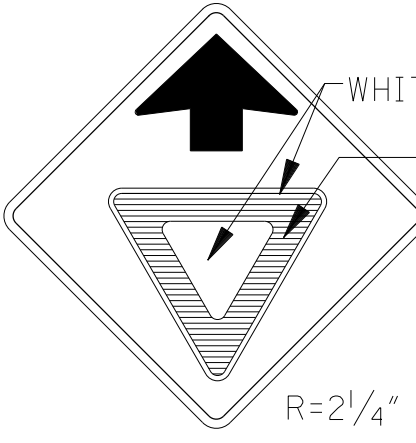
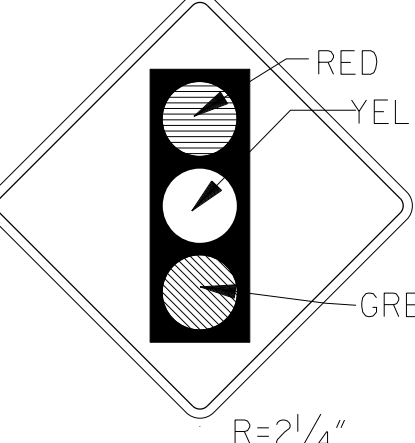
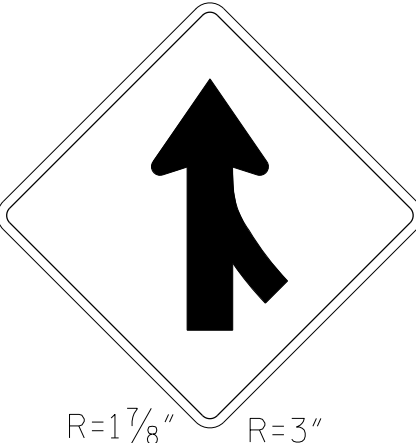
BY	MISSISSIPPI DEPARTMENT OF TRANSPORTATION ROADWAY DESIGN DIVISION STANDARD PLAN
REVISION	<b>STANDARD ROADSIDE SIGNS</b>
DATE	ISSUE DATE: JULY 2015
WORKING NUMBER	SN-3A
SHEET NUMBER	6223

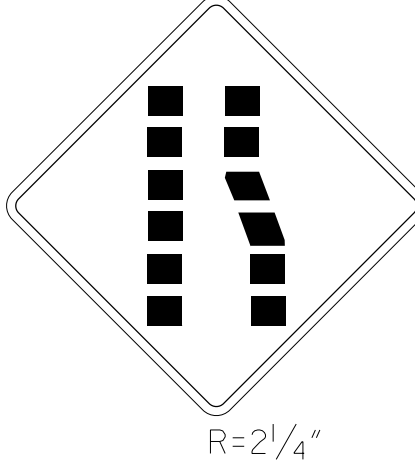
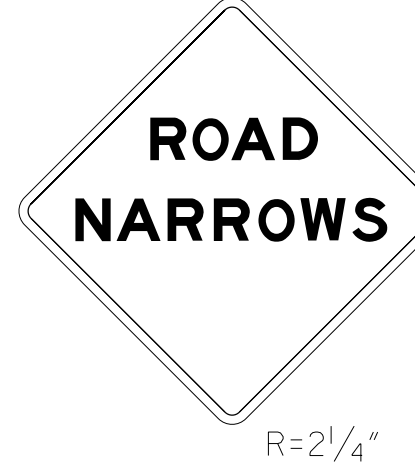

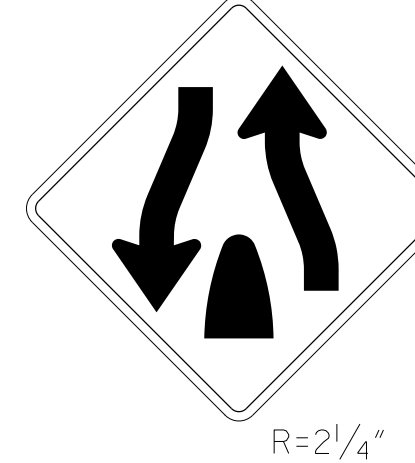
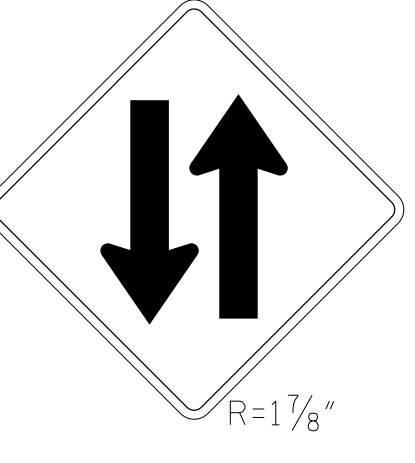
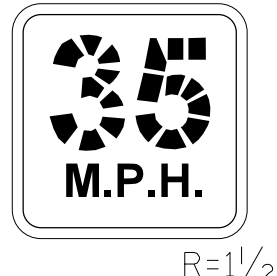
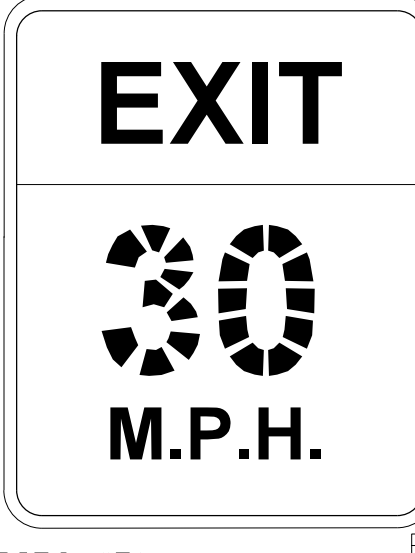
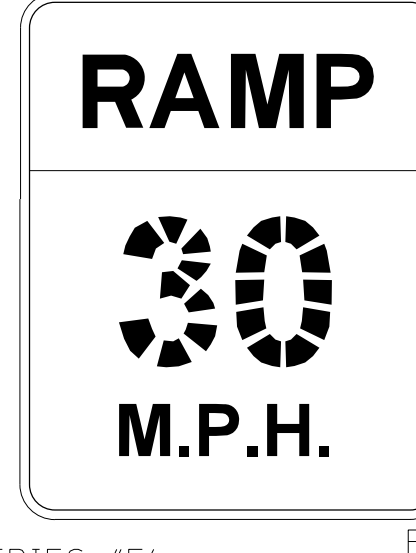
SIGN NUMBER	W1-1L W1-1R	W1-2L W1-2R	W1-3L W1-3R	W1-4L W1-4R	W1-6L W1-6R	W1-7	W3-1a	W3-2a	W3-3	W4-1L W4-1R	W4-101L W4-101R
ALUMINUM (6061-T6) SIGN BLANK THICKNESS	0.125"	0.125"	0.125"	0.125"	0.125"	0.125"	0.125"	0.125"	0.125"	0.125"	0.125"
LEGEND	 R=1 7/8"	 R=1 7/8"	 R=1 7/8"	 R=1 7/8"	 R=1 7/8"	 R=1 7/8"	 R=2 1/4"	 R=2 1/4"	 R=2 1/4"	 R=1 7/8" R=3"	
LETTER & NUMERAL SERIES											
WIDTH OF BORDER	INSIDE OUTSIDE	INSIDE OUTSIDE	INSIDE OUTSIDE	INSIDE OUTSIDE	INSIDE OUTSIDE	INSIDE OUTSIDE	INSIDE OUTSIDE	INSIDE OUTSIDE	INSIDE OUTSIDE	INSIDE OUTSIDE	INSIDE OUTSIDE
SIZE (WIDTH X HEIGHT)	30" X 30"	30" X 30"	30" X 30"	30" X 30"	48" X 24"	48" X 24"	36" X 36"	36" X 36"	36" X 36"	30" X 30"	48" X 48"
COLORS	COPY BACKGROUND	COPY BACKGROUND	COPY BACKGROUND	COPY BACKGROUND	COPY BACKGROUND	COPY BACKGROUND	COPY BACKGROUND	COPY BACKGROUND	COPY BACKGROUND	COPY BACKGROUND	COPY BACKGROUND
REFLECTORIZATION	BACKGROUND	BACKGROUND	BACKGROUND	BACKGROUND	BACKGROUND	BACKGROUND	BACKGROUND & SYMBOL	BACKGROUND & SYMBOL	BACKGROUND & "LIGHTS"	BACKGROUND	BACKGROUND
NUMBER OF POSTS FOR MOUNTING	1	1	1	1	2	2	1	1	1	1	1
NUMBER OF HOLES TO BE PUNCHED (3/8" DIA.)	2	2	2	2	4	4	2	2	2	2	4
PUNCHING DISTANCE FROM EACH VERT. EDGE	VERT. CENTER	VERT. CENTER	VERT. CENTER	VERT. CENTER	6"	6"	VERT. CENTER	VERT. CENTER	VERT. CENTER	VERT. CENTER	14 1/2" FROM VERT. CENTER
PUNCHING DISTANCE FROM TOP EDGE	15" FROM HORIZ. CENTER	15" FROM HORIZ. CENTER	15" FROM HORIZ. CENTER	15" FROM HORIZ. CENTER	3"; 21"	3"; 21"	18" FROM HORIZ. CENTER	18" FROM HORIZ. CENTER	18" FROM HORIZ. CENTER	15" FROM HORIZ. CENTER	14 1/2" FROM HORIZ. CENTER

SIGN NUMBER	W4-2	W5-1	W6-1	W6-2	W6-3	W13-1	W13-2	W13-3	W10-1	W10-101
ALUMINUM (6061-T6) SIGN BLANK THICKNESS	0.125"	0.125"	0.125"	0.125"	0.125"	0.080"	0.125"	0.125"	0.125"	0.125"
LEGEND	 R=2 1/4"	 R=2 1/4"	 R=2 1/4"	 R=2 1/4"	 R=1 7/8"	 R=1 1/2"	 R=3"	 R=3"		
LETTER & NUMERAL SERIES		6" SERIES "D"				8" SERIES "E" 3" SERIES "E"	8" SERIES "E" 16" SERIES "E" 6" SERIES "E" (SEE NOTE)	8" SERIES "E" 16" SERIES "E" 6" SERIES "E" (SEE NOTE)	8" SERIES "E" 10" SERIES "E"	
WIDTH OF BORDER	INSIDE OUTSIDE	INSIDE OUTSIDE	INSIDE OUTSIDE	INSIDE OUTSIDE	INSIDE OUTSIDE	INSIDE OUTSIDE	INSIDE OUTSIDE	INSIDE OUTSIDE	INSIDE OUTSIDE	INSIDE OUTSIDE
SIZE (WIDTH X HEIGHT)	36" X 36"	36" X 36"	36" X 36"	36" X 36"	30" X 30"	18" X 18"	48" X 60"	48" X 60"	36" DIAMETER	48" DIAMETER
COLORS	COPY BACKGROUND	COPY BACKGROUND	COPY BACKGROUND	COPY BACKGROUND	COPY BACKGROUND	COPY BACKGROUND	COPY BACKGROUND	COPY BACKGROUND	COPY BACKGROUND	COPY BACKGROUND
REFLECTORIZATION	BACKGROUND	BACKGROUND	BACKGROUND	BACKGROUND	BACKGROUND	BACKGROUND	BACKGROUND	BACKGROUND	BACKGROUND	BACKGROUND
NUMBER OF POSTS FOR MOUNTING	1	1	1	1	1	1	1	1	1	1
NUMBER OF HOLES TO BE PUNCHED (3/8" DIA.)	2	2	2	2	2	2	6	6	2	4
PUNCHING DISTANCE FROM EACH VERT. EDGE	VERT. CENTER	VERT. CENTER	VERT. CENTER	VERT. CENTER	VERT. CENTER	9" (VERT. CENTER)	10"	10"	15"	15" (VERT. CENTER)
PUNCHING DISTANCE FROM TOP EDGE	18" FROM HORIZ. CENTER	18" FROM HORIZ. CENTER	18" FROM HORIZ. CENTER	18" FROM HORIZ. CENTER	15" FROM HORIZ. CENTER	3"; 15"	4"; 30"; 56"	4"; 30"; 56"	3"; 33"	5"; 43"

GENERAL NOTES:

1. THE QUANTITIES LISTED ON THE SUMMARY OF QUANTITIES SHEET FOR THE SIGNS SHOWN ON THIS SHEET WILL BE USED AS THE BASIS FOR FINAL PAYMENT, EXCEPT WHERE SIGNS ARE MODIFIED FROM THAT SHOWN.
2. SIGNS W13-2 AND W13-3- THE STROKE WIDTH OF THE LETTER AND NUMERALS SHALL BE WIDENED TO 20% OF THE LETTER OR NUMERAL HEIGHT.
3. THE SPEEDS REQUIRED ON SIGNS W13-1, W13-2 AND W13-3 WILL BE SHOWN ON INDIVIDUAL PLAN SHEETS.

MISSISSIPPI DEPARTMENT OF TRANSPORTATION  
ROADWAY DESIGN DIVISION  
STANDARD PLAN

**STANDARD  
ROADSIDE SIGNS**

WORKING NUMBER  
SN-3B  
SHEET NUMBER  
6224

ISSUE DATE: JULY 2015



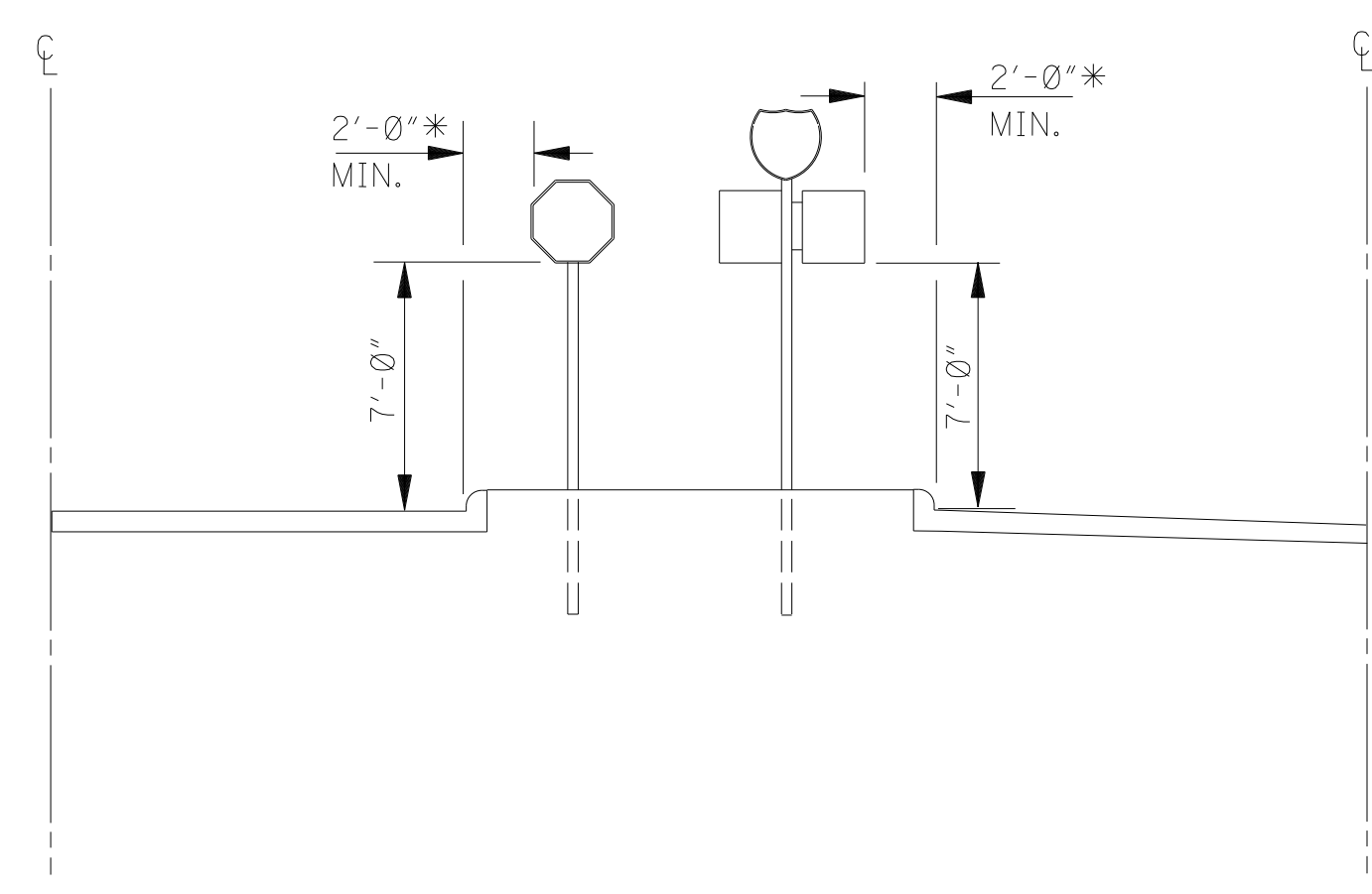

TYPICAL INSTALLATION IN ISLANDS OFF OF (OR ADJACENT TO) INTERSTATE MAIN FACILITY

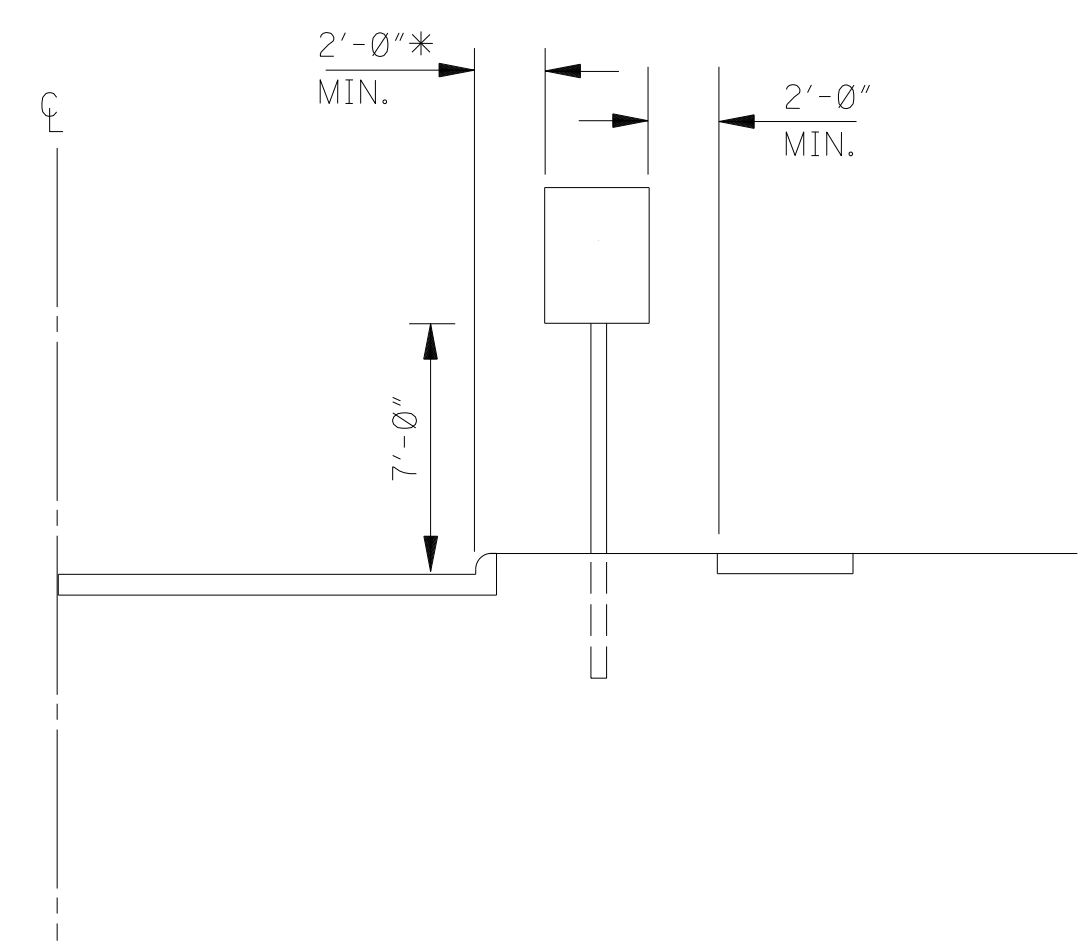
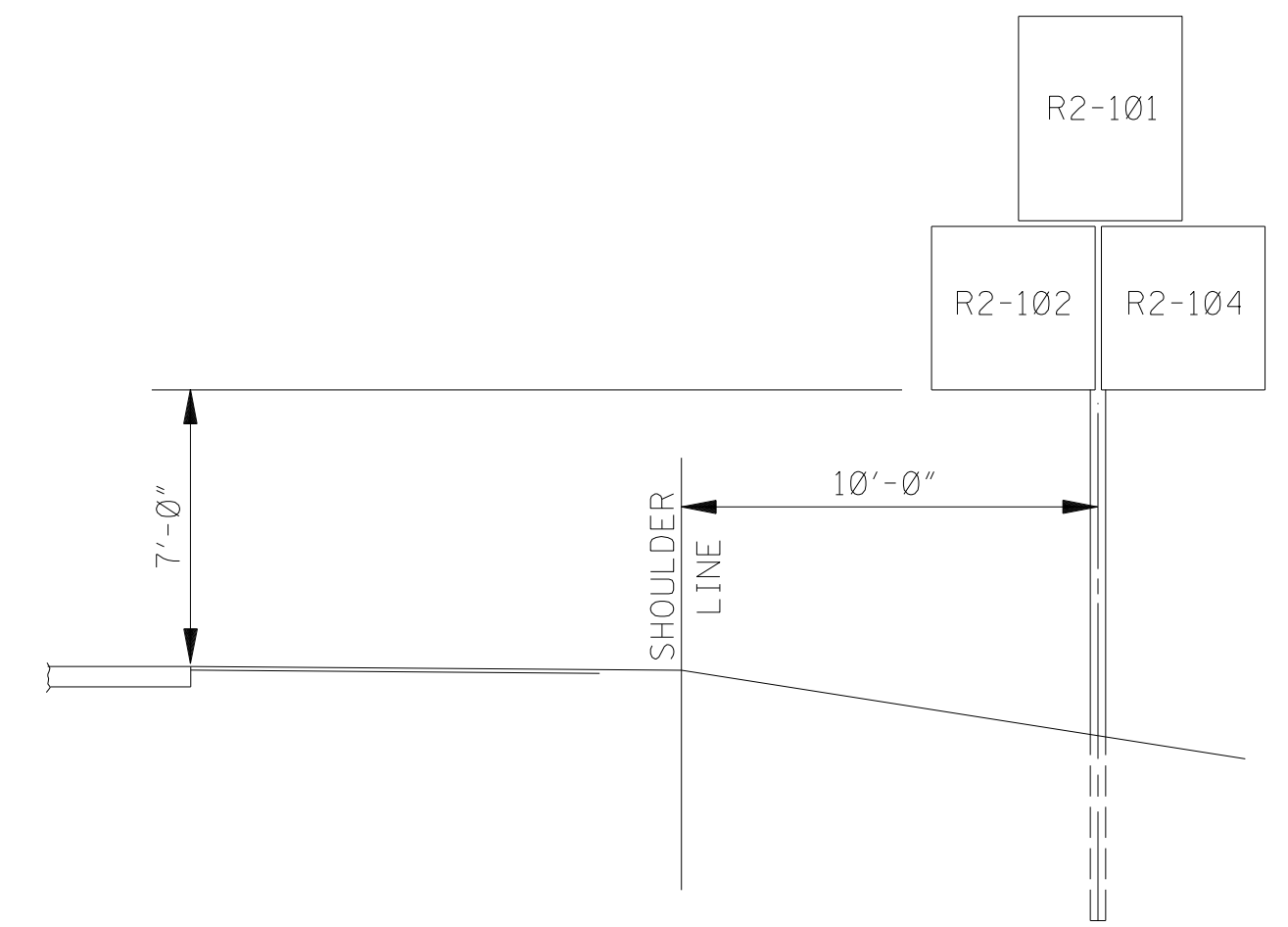
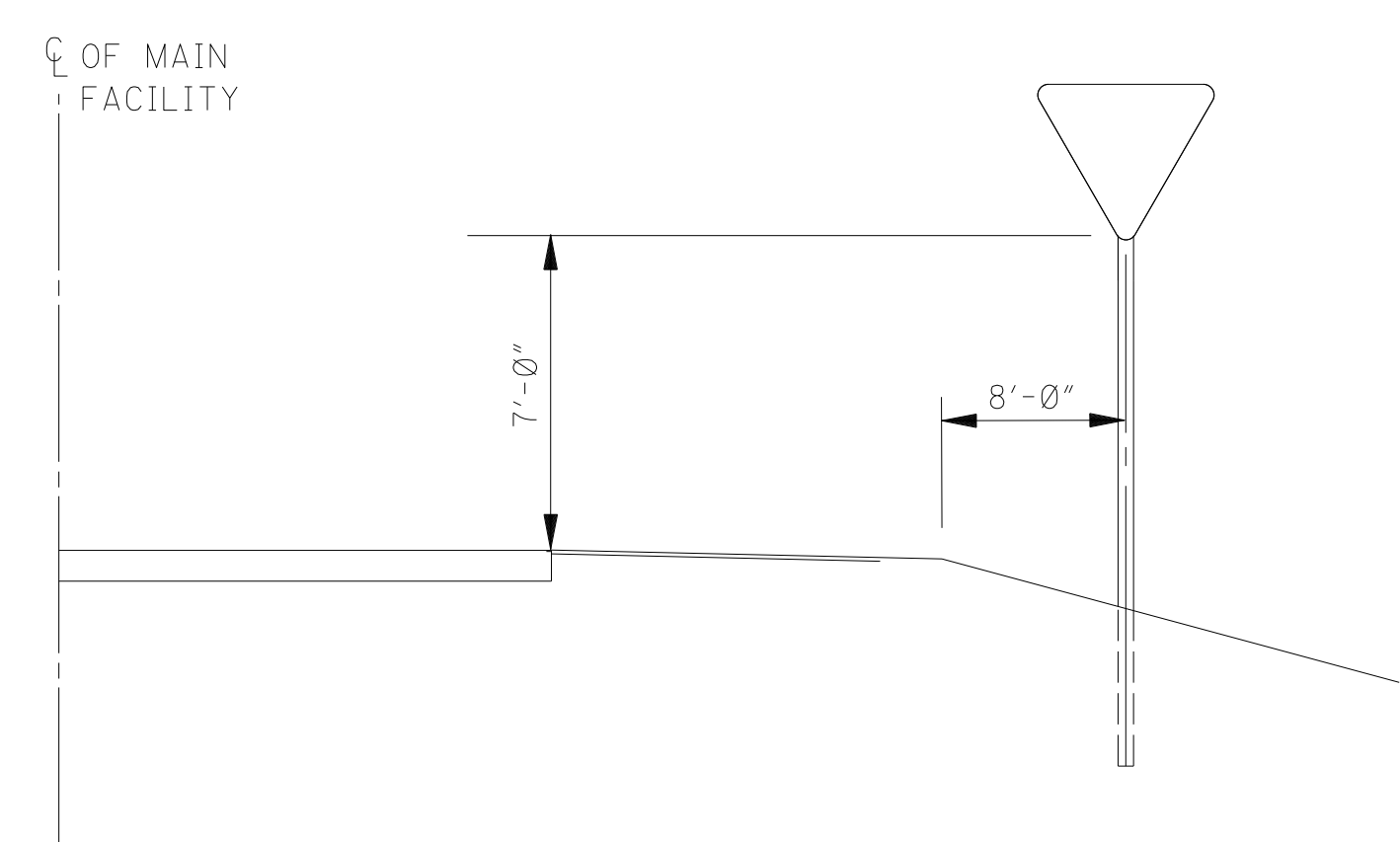

TYPICAL INSTALLATION ALONG FRONTAGE ROAD, RAMP OR STREET WHERE THERE IS NOT A USABLE SHOULDER

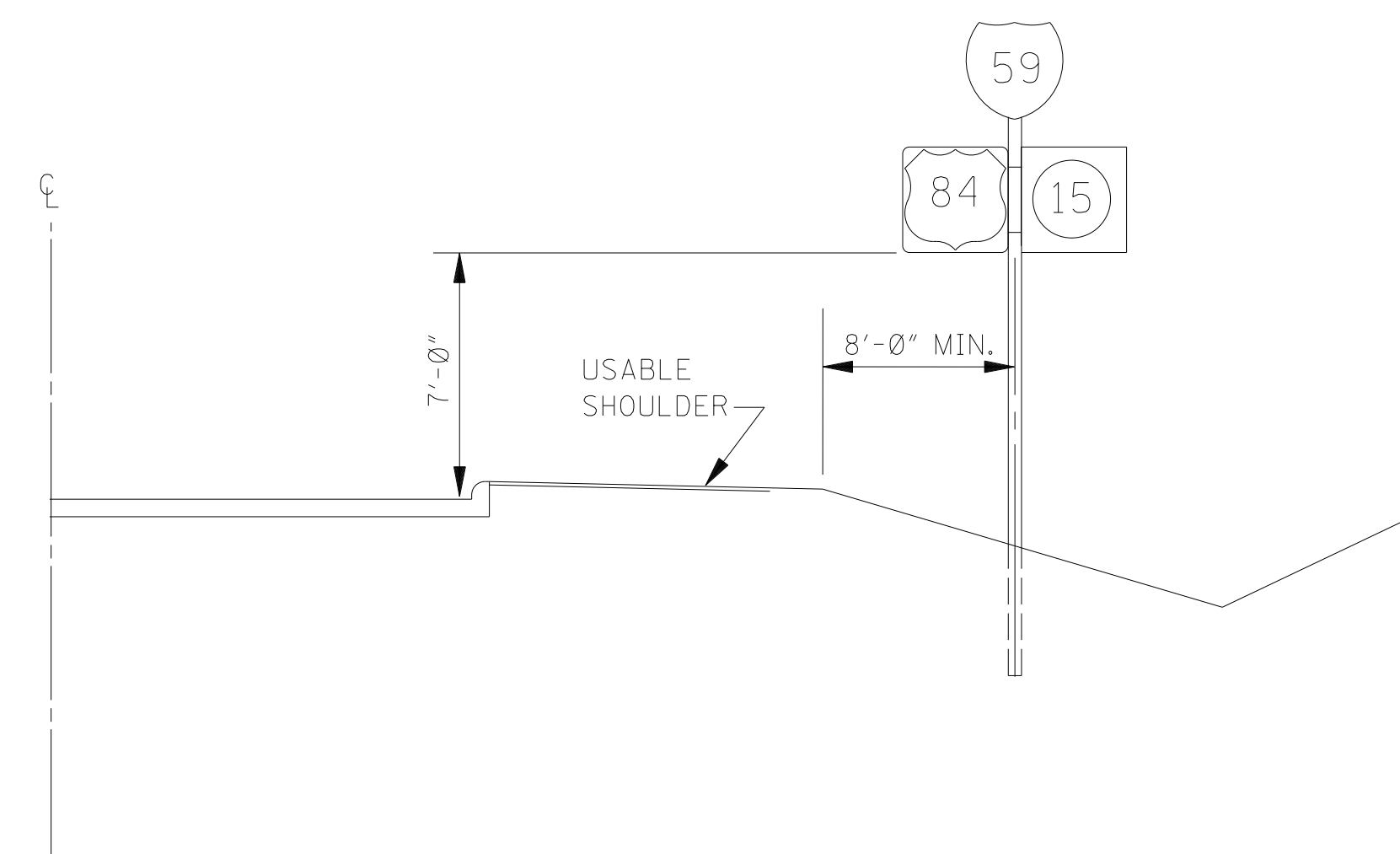

TYPICAL INSTALLATION ALONG THE INTERSTATE MAIN FACILITY AND ALONG RAMPS, FRONTAGE ROADS AND HIGHWAYS

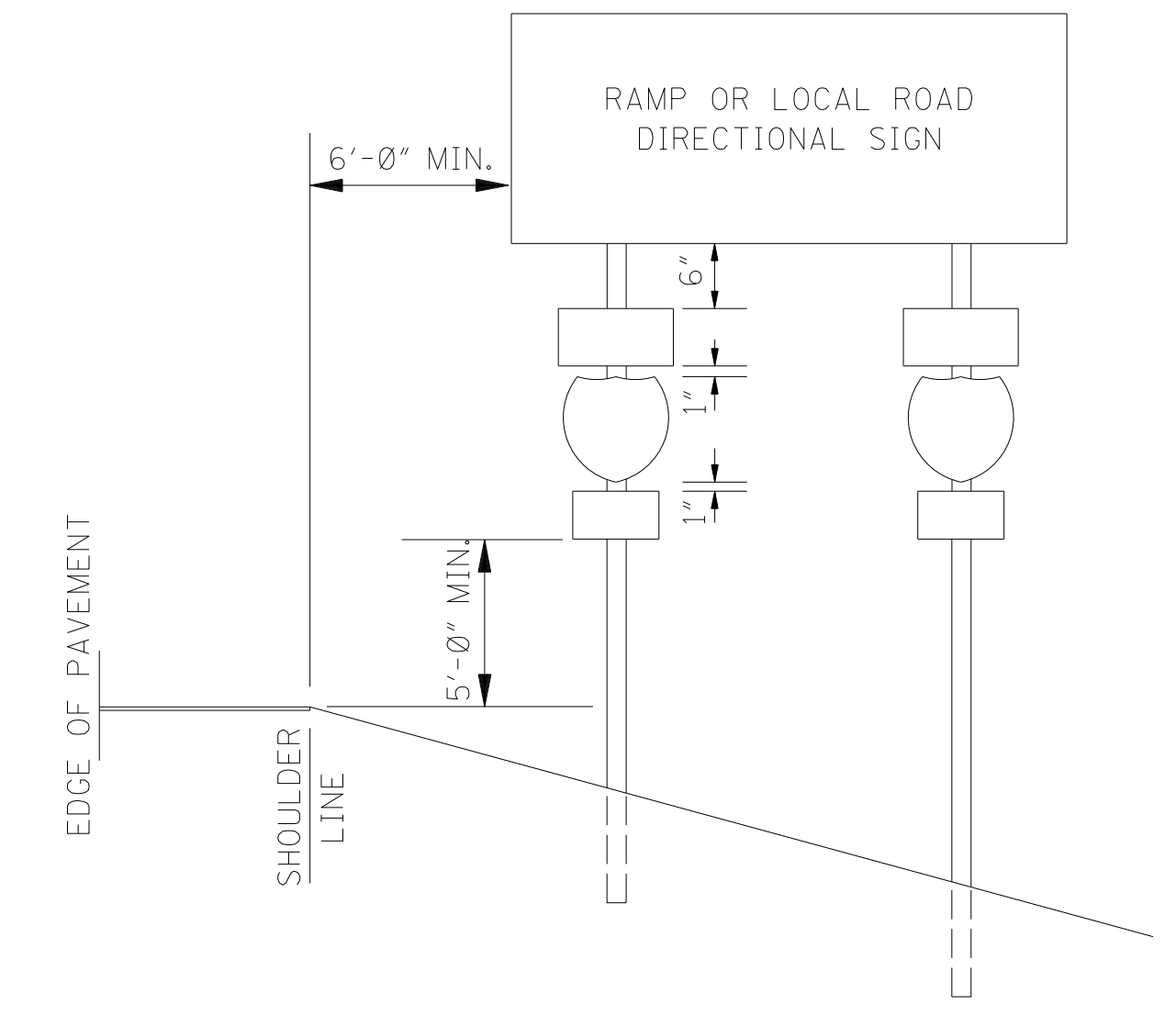

\* NOTE: THE 2'-0" MINIMUM OFFSET APPLIES ONLY TO STANDARD SIGNS MOUNTED ON U-SECTION POSTS. ALL STANDARD SIGNS MOUNTED ON PIPE WILL BE OFFSET A MINIMUM OF 4'-0". RAMP DESTINATION SIGNS WILL BE OFFSET 4'-0" FROM SHOULDERS.

MISSISSIPPI DEPARTMENT OF TRANSPORTATION ROADWAY DESIGN DIVISION STANDARD PLAN	
<b>STANDARD ROADSIDE SIGN ASSEMBLY AND INSTALLATION</b>	
WORKING NUMBER SN-4	SHEET NUMBER 6225
DATE	ISSUE DATE: JULY 2015



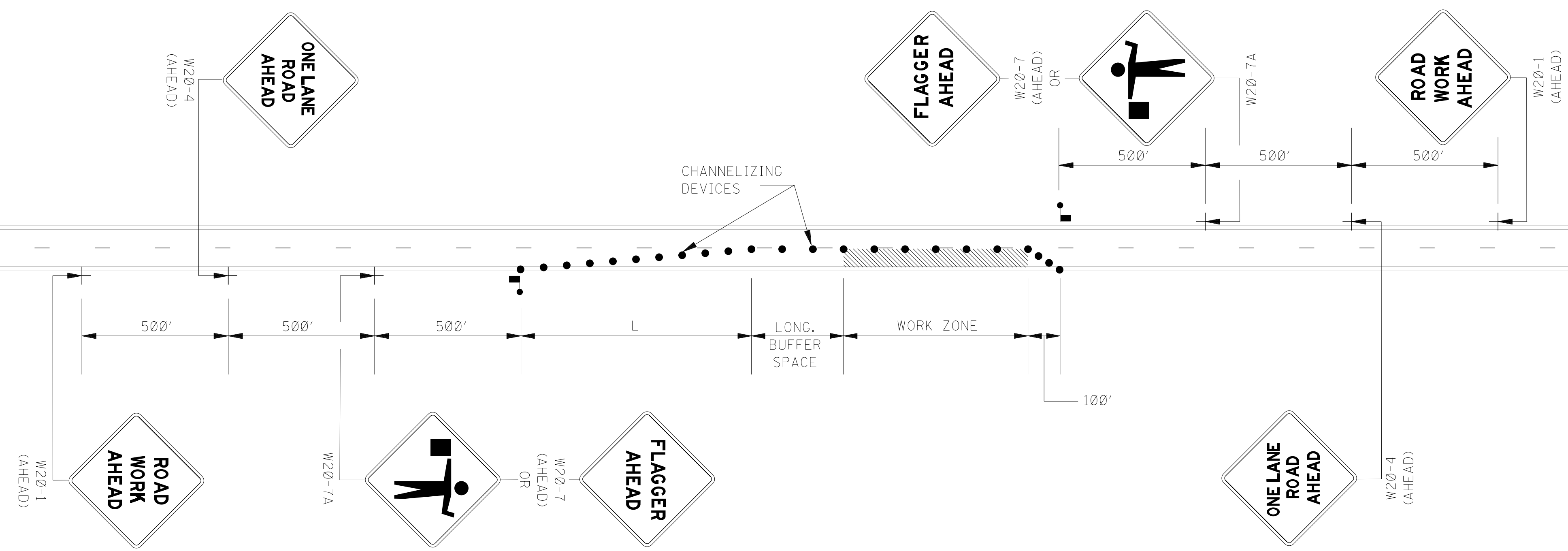

LEGEND

- FLAGGER
- CHANNELIZING DEVICES

GENERAL NOTES:

1. THE LOCATION OF CHANNELIZING DEVICES AND THE WORK AREA LAYOUT SHALL BE BASED ON THE CRITERIA IN THE FOLLOWING TABLE:

POSTED SPEED AND/OR DESIGN SPEED	MAXIMUM CHANNELIZING DEVICE SPACING (ft)		MINIMUM LONGITUDINAL BUFFER SPACE (ft)	TAPER + RATES
	TAPER	ALONG LANE LINE & WORK ZONE		
mph				
≤40	40	80	170	27:1
45	45	90	220	45:1
50	50	100	280	50:1
55	55	110	335	55:1
60	60	120	415	60:1
65	65	130	485	65:1
70	70	140	575	70:1

+ NOTE: TAPER RATES ARE DETERMINED USING THE FOLLOWING EQUATIONS:  
 $L = WS$  FOR SPEEDS OF 45 mph OR GREATER  
 $L = WS^2/60$  FOR SPEEDS OF 40 mph OR LESS  
 WHERE: L = MINIMUM LENGTH OF TAPER IN FEET  
 W = WIDTH OF OFFSET (USUALLY LANE WIDTH) IN FEET  
 S = DESIGN SPEED OR 85TH PERCENTILE SPEED IN MILES PER HOUR

2. ALL CHANNELIZING DEVICES SHALL BE A MINIMUM OF 24" IN HEIGHT.
3. ALL TRAFFIC CONTROL ITEMS SHOWN ON THIS SHEET WILL NOT BE MEASURED FOR SEPARATE PAYMENT. THIS WORK IS TO BE INCLUDED IN THE PRICE BID FOR MAINTENANCE OF TRAFFIC.
4. DIAMOND SHAPED TRAFFIC CONTROL SIGNS SHALL BE A MINIMUM OF 48" x 48".
5. WHEN THERE IS NO EXISTING HAZARD OR AT THE END OF THE WORK DAY, ALL SIGNS SHALL BE COVERED OR REMOVED AND ALL CHANNELIZING DEVICES SHALL BE MOVED TO THE SHOULDER EDGE.
6. WHERE THE WORK ZONE IS STATIONARY, THE W20-7 (500 FT.) SIGN OR THE W20-7A SIGN TOGETHER WITH THE W20-7 (500 FT.) SUPPLEMENTAL PLATE SHOULD BE USED TO INDICATE THE DISTANCE TO THE FLAGGER.

BY		MISSISSIPPI DEPARTMENT OF TRANSPORTATION ROADWAY DESIGN DIVISION STANDARD PLAN	
REVISION		<b>TRAFFIC CONTROL PLAN WITH FLAGGER (ONE-LANE CLOSURE OF TWO-WAY TRAFFIC)</b>	
DATE	ISSUE DATE: JULY 2015		
		WORKING NUMBER TCP-1	SHEET NUMBER 6290